

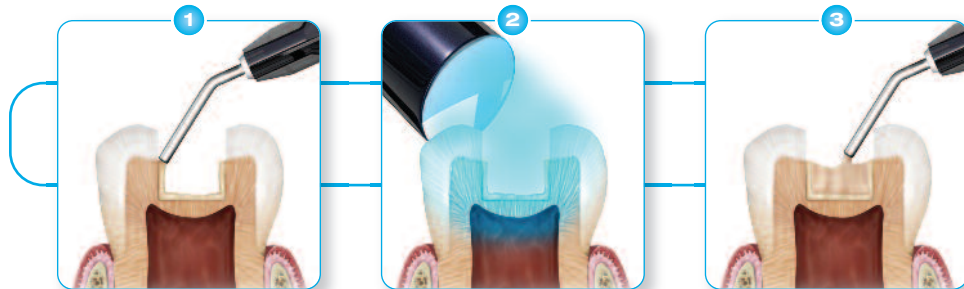

Chairside Prep Guide



Apply **Fusio™** material in 1mm increments. Agitate with tip or brush for 20 seconds.

Light cure 10 seconds. (If using as a **Base Liner** proceed to Step 4).

Apply additional 2mm increments. Light cure each increment 10 seconds.

Etch, bond, and light cure.

Apply **Artiste®** composite in 2mm increments. Light cure each increment 10 seconds.

Finish & polish.

Dentin Replacement and Base Liner Instructions



CEpartner4U, Esdoornlaan 13, 3951DB Maarn. The Netherlands. tel: +31 (0)6.516.536.26

Assembled in USA

05J595 Rev02

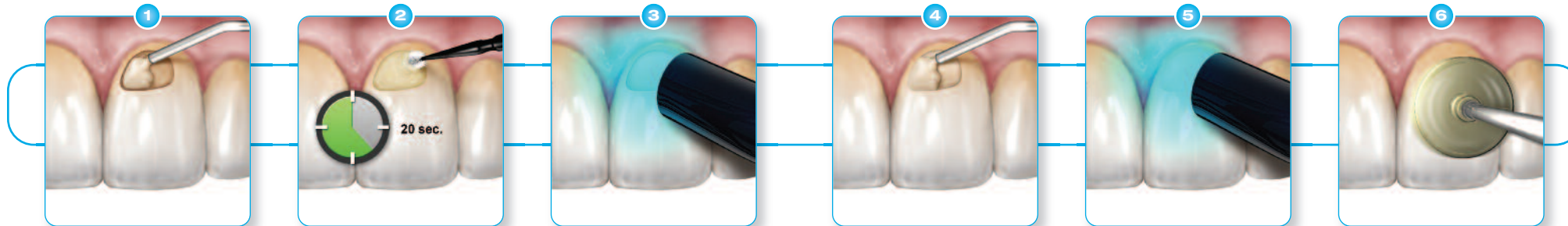

Apply 1mm increment.

Agitate for 20 seconds with the needle tip or a brush tip.

Light cure for 10 seconds.

Apply additional 2mm increments as needed and light cure each 10 seconds.

Light cure final increment an additional 10 seconds.

Finish & polish.

Instructions for Class I, III, V, and Blocking Out Undercuts

IMPORTANT NOTE: For Class V preparations with caries, ensure there is a physically present and well defined cavity preparation. Create an outline form removing all caries at DEJ and all decalcified enamel. Place a bevel on all enamel margins.